

FORM B – BUILDING

MASSACHUSETTS HISTORICAL COMMISSION
MASSACHUSETTS ARCHIVES BUILDING
220 MORRISSEY BOULEVARD
BOSTON, MASSACHUSETTS 02125

Photograph



Topographic or Assessor's Map

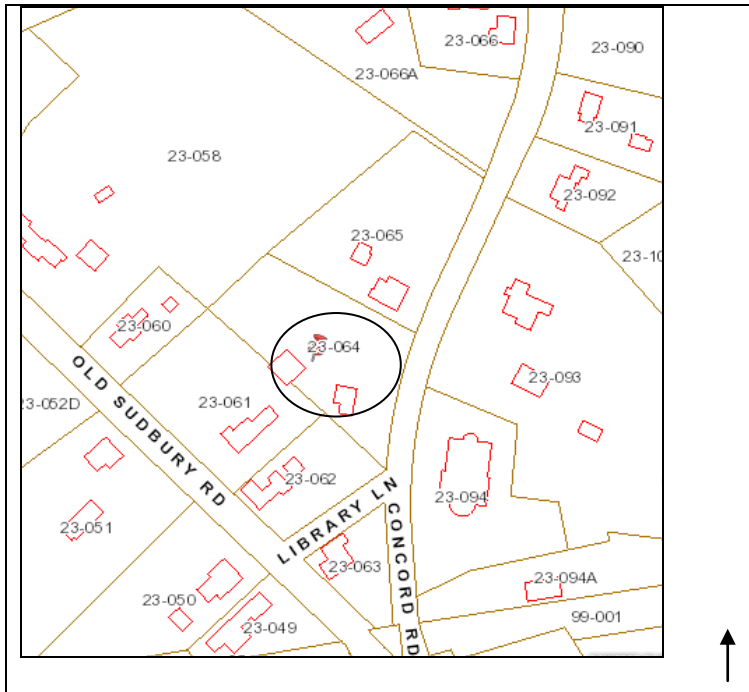

Assessor's Number USGS Quad Area(s) Form Number

023-064

Natick

WAY.37

Town: WAYLAND

Place: (*neighborhood or village*)

Address: 8 Concord Road

Historic Name: Fowler, Frederick H. House

Uses: Present: single-family residential

Original: single-family residential

Date of Construction: 1893

Source: maps and visual

Style/Form: Colonial Revival

Architect/Builder: unknown

Exterior Material:

Foundation: rubblestone w/ mortar

Wall/Trim: wood clapboards

Roof: asphalt shingles

Outbuildings/Secondary Structures: pre-1905 gabled roof barn with center gable peak and cupola

Major Alterations (*with dates*): mid 20th C. rear additions; late 20th C. solar collectors on roof

Condition: good

Moved: no | x | yes | | **Date** n/a _____

Acreage: less than one acre

Setting: Residential neighborhood at town center, opposite 1900 brick public library. At Concord Rd. and Library Ln. Early 19th C. dwellings behind on Old Sudbury Rd. High board fence around property and obscuring façade as it lines front along road edge. Mature trees.

Recorded by: Gretchen G. Schuler

Organization: for Wayland Historical Commission

Date (*month / year*): February 2012/September 2012

INVENTORY FORM B CONTINUATION SHEET

WAYLAND

8 CONCORD ROAD

MASSACHUSETTS HISTORICAL COMMISSION

220 MORRISSEY BOULEVARD, BOSTON, MASSACHUSETTS 02125

Area(s) Form No.

WAY.37

☒ Recommended for listing in the National Register of Historic Places.

If checked, you must attach a completed National Register Criteria Statement form.

Use as much space as necessary to complete the following entries, allowing text to flow onto additional continuation sheets.

ARCHITECTURAL DESCRIPTION: *Describe architectural features. Evaluate the characteristics of this building in terms of other buildings within the community.*

The Frederick Fowler House is a two and one-half story, wood clapboard, side-gable dwelling that is three bays wide and two deep. Two-story projecting bays are attached to the north and south side elevations. Two later single-story additions project from the rear of the house – one wrapping to the north elevation from the west and the other on the west/rear side of the dwelling. A near full-width, hipped-roof porch stretches across the main façade. It is carried by squared tapered posts that rise to segmental arched openings. A turned balustrade extends between the posts and runs along the side of the centered wood steps. Within the porch is a center entry, which has a paneled door with a large glass square light that is decorated with a slightly smaller square formed by narrow muntin bars and a diamond within the interior square formed by muntin bars connecting the sides of the square light. First-story double hung windows have 2/1 sash while those above have 2/2 sash. Wood louvered shutters flank each window including those in the projecting bays. In each gable peak there is a window of three long single lights. A solar panel rests on the bottom of the front (east) roof slope. A single chimney rises behind the ridge on the north end of the building.

HISTORICAL NARRATIVE *Discuss the history of the building. Explain its associations with local (or state) history. Include uses of the building, and the role(s) the owners/occupants played within the community.*

Wayland Center changed rapidly with the advent of the Massachusetts Central Railroad which passed through in 1881. This commodious house represents the beginning of a gradual transition from an agricultural community to a rural residential one in which residents could commute to Boston on the nearby railroad.

Frederick H. Fowler (b. 1866), who worked as a clerk in Boston, arrived from Belmont and purchased 16 acres of land from Warren Gould Roby who had built the commodious and elaborate Colonial Revival house at 11 Concord Road in 1888. Fowler and his wife, **Martha "Mattie" Scott Fowler** (married in 1888), built this house and moved here in 1893 after which Fowler is reported to have purchased surrounding land in order to build other village housing; however there is no evidence on maps or deeds that Fowler owned additional lots with the exception of about an acre that he sold to Alice Dickey which she combined to enlarge 15 Old Sudbury Road in about 1910. While living in Wayland, Fowler commuted by railroad to the State House in Boston where he worked for the Massachusetts Board of Agriculture. By 1910 (Census) Fowler resided in Shirley where he worked for the Industrial School for Boys (MHC.SRL.B). For a few years the house may have been rented to the Lawrence family who appear in the 1910 census near Brackett who owned 11 Concord Road by that date. However in 1917 the Fowlers were back in their Concord Road house according to street directories and then the 1919 directory reported that they had removed to Shirley again. Fowler worked in Shirley and resided in Pepperell.

Arthur R. and Louise Havener purchased this dwelling from Fowler in 1917. According to the 1920 Census they lived here with their two daughters (16 years and 9 years of age). In 1922 their young son, Arthur Roy Havener, Jr. (1922-1976) was born. Arthur Sr. (1880-1953) was a civil engineer who invented various types of machinery and had worked as a draftsman when a young man. By 1930 only Arthur, Louise and their son Arthur Roy lived here as the daughters had moved away from the family home. In 1953 when Arthur Sr. died, his then wife, **Helen S. Havener** sold the house to **John T. and Eleanor R. Howard**.

INVENTORY FORM B CONTINUATION SHEET

WAYLAND

8 CONCORD ROAD

MASSACHUSETTS HISTORICAL COMMISSION

220 MORRISSEY BOULEVARD, BOSTON, MASSACHUSETTS 02125

Area(s) Form No.

WAY.37

BIBLIOGRAPHY and/or REFERENCES

Atlas/Maps: 1908 Walker (F.H. Fowler), 1946 Brooks (Arthur R. Havener).

Directories, Waltham Suburban and Weston-Wayland Directories. 1893, 1906-07, 1911-12, 1913-14, 1915, 1917, 1918, 1919.

Emery, Helen. *The Puritan Village Evolves*. Canaan, NH: Phoenix Publishing. 1981.

Emery, Helen. MHC Survey Form. 1977

Middlesex Registry South. Book 2144, Page 312; Book 2172, Page 99.

Oral History. Family Descendant.

United States Federal Census. 1910, 1920, 1930.

Wayland Historical Society.

Wayland Valuation List. 1900.

MASSACHUSETTS HISTORICAL COMMISSION
MASSACHUSETTS ARCHIVES BUILDING
220 MORRISSEY BOULEVARD
BOSTON, MASSACHUSETTS 02125

WAYLAND 8 Concord Road

Area(s) Form No.

	WAY.37
--	--------

National Register of Historic Places Criteria Statement Form

Check all that apply:

- ☐ Individually eligible ☒ Eligible **only** in a historic district
- ☒ Contributing to a potential historic district ☐ Potential historic district

Criteria: ☒ **A** ☐ **B** ☒ **C** ☐ **D**

Criteria Considerations: ☐ **A** ☐ **B** ☐ **C** ☐ **D** ☐ **E** ☐ **F** ☐ **G**

Statement of Significance by _____ Gretchen G. Schuler _____
The criteria that are checked in the above sections must be justified here.

The Frederick H. Fowler House is eligible for listing in the National Register of Historic Places as part of a Wayland Center Historic District. It is a village house built in 1893 after the railroad had become a prominent feature of Wayland Center changing the landscape with the ability to commute to Boston. The property retains integrity of location, setting, design, materials, craftsmanship, feeling and association.