

Wayland Historical Commission
Meeting Minutes
February 19, 2019
Selectmen's Hearing Room, Wayland Town Building

Present: Kay Westcott, Richard Conard, Ann Gordon, Tonya Largy, John Dyer
Guests: Asa Foster, Tom Sciacca

The meeting was called to order at 7:31pm

The Commission warmly welcomed John Dyer back after his recent absence.

Public Comment

- Tom Sciacca would like to comment on the Loker Field

Loker Field

- Kay, Tonya and Sheila Carel walked the field with Katherine Brenna recently
- There are two areas of archaeological sensitivity
- The original work plan did not come near the area where ceremonial stones may be resting, but now the work plan is moving closer to that area
- The Recreation Dept. wants to send bid documents out within the next month
- They want a \$3.75M debt exclusion though they don't think it will cost that much
- The plan calls for taking out 400 trees, many of which are small, but some of which are large deciduous and white pines
- Kay wonders if some of the larger trees could be cut flush to the ground rather than digging out the roots; this will save money and be less disturbing
- Asa Foster feels this is doable, but also says the whole area has already been disturbed
- The post and fence near the ceremonial stones will not be disturbed
- The work zone on the west side (land between Rice Road and the playing field) will be moved closer to the field and have a survey done before work starts to be sure there are no archaeological sensitivities in the area or in the extended portion of the parking lot.
- Archaeological monitoring is required for the removal of the trees and digging into the ground for planting new trees. Monitoring is also required when working next to or in the sensitive areas. A Native American consultant will monitor the sensitive areas.
- There is a concern with the movement of the earth in the wetland near what is currently called the North Pond that should be monitored since waterways are often associated with Native American culture.
- It is estimated to cost \$85-90/hour for Native American monitoring including travel time, gas, any necessary overnight housing, on areas that have already been identified and two that have not yet been identified, one near the parking lot and one down the hill on the west side
- Who writes the scope of work for the archaeological monitor on the project?
- Tonya will speak with Louise Miller about this; we need to specify what we want done
- Tom Sciacca advises us to make sure we get what we want/need, and not compromise to help this project go forward
- Kay stated that the WHC will not compromise on our standards or what we feel is in our purview regarding this project. We are neither for nor against the field, we have our own specific concerns.

- There is an alternate petitioners' proposal for a smaller grass field; the WHC may be asked if the smaller project would be preferable from our viewpoint
- Kay thinks the monitoring would be about the same

Stone's Bridge

- Louise Miller contacted the Commission to find the town boundary between Framingham and Wayland
- Framingham says they don't own part of the bridge, but we have historical documents showing that in 1945 Wayland and Framingham worked together to restore the bridge (see Appendix A).
- In addition, a 1957 plan found by Rick Conard shows the boundary (see Appendix B).
- Attached are documents showing some of the history

Minutes

- The minutes of the Jan. 2019 meeting were reviewed and approved pending Kay's research into how to correct an erroneous statement

Rail Trail and Depot

- Rick is trying to find out the status of the Depot project but has not yet heard back from Ben Keefe

Archaeology

Dudley Woods

- Bids have been submitted for the Dudley Woods project but an award has not yet been made
- Recreation is vetting the lowest three bidders

Gardescu Bench

- Amanda submitted an estimate for a bench, which is about \$600
- Additional costs would be for a plaque and possibly for a concrete pad and mounting the bench to it
- We will all continue to research and everyone is encouraged to bring a bench proposal to the March meeting

Budget

- Tonya received a bill for the archaeology event in Oct. but it was \$100 higher than usual
- It included a room rental fee, which was a mistake
- Tonya got it straightened out

Form for Town Projects

- WHC has not been in the workflow given to project leaders when they have a town project, which is why we have not been consistently notified about construction or other projects around town that we are interested in
- Kay met with Louise Miller and we will be added to the workflow
- Tonya and Amanda developing a form for project leaders to fill out

Explaining the Importance of Archaeology

- Tabled until next meeting, but members are encouraged to email Kay with their thoughts on why archaeology is important

Misc. Archeology

- UMass shut down their archaeological services program
- We don't yet have a completed report on the Dorey House, and Tonya has been in touch with them about this
- Mass Historic Commission asked for a detailed table of what came out of the fill at Dorey House

Backpack Auction

- Amanda and Tonya are working on this upcoming event in the schools

Castlegate Pillars Article for QR Code on Sign

- A draft article about the Mansion Inn history was approved with the last round of changes
- It was suggested we date the article on the website so we can continue to update it
- We will put it on the website now and link to it when the Pillar signs are erected

Next Meetings

- March 12
- April 9
- May 14
- June 11

The meeting was adjourned at 9:32pm.

Respectfully submitted,

Ann Gordon

ANNUAL REPORT^{ext} of the TOWN OF FRAMINGHAM for the YEAR ENDING DECEMBER 31, 1945 and Statements of the appropriations and Expenditures for the Financial Year Ending December 31, 1945

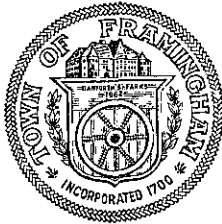

Population (1945 Census)	25,502
Number of Polls.....	8,261
Area of Town in Square Miles.....	24.8
Miles of Highway.....	117.69
Value of Town Property.....	\$8,813,335
Assessed Valuation of Town for 1945	
Real Estate	\$30,775,437.00
Personal	3,201,176.00
Total Valuation.....	\$33,976,613.00
Tax rate per \$1,000 of valuation for 1945.....	32.80

Potter Road Bridge:

Appropriation	Expended	Balance
\$1,000.00	\$959.32	\$40.68

Aleda Street Construction:

Appropriation	Expended	Balance
\$1,500.00	\$1,421.39	\$78.61

New Street Construction:

Appropriation	Expended	Balance
\$17,548.10	\$16,007.83	\$1,540.27

This appropriation was carried over from 1944, and the following newly accepted streets were constructed this year:

Centennial Place	\$1,838.03
Bellmore Road	1,542.37
Vose Street	5,289.27
Pershing Avenue	3,076.02
Fenwood Street	1,702.72
Dinsmore Avenue	839.89
Bridges St. Extension.....	314.09
Andrews St. Completion	260.52
Auburn Street	1,144.92

Total.....	\$16,007.83
------------	-------------

Owing to weather conditions there were one or two streets which we were unable to complete this year. The balance of this appropriation will be used to complete these streets in the spring.

New Equipment:

Appropriation	Expended	Balance
\$25,000.00	\$17,592.52	\$7,407.48

The following pieces of equipment were purchased under this appropriation:

1942 Dodge Sedan	\$1,200.00
Belt Conveyor	500.00
1 Buckeye Spreader.....	630.72
1 Case Tractor.....	1,860.77
1 General Motors Truck.....	4,875.00
14 Tires (Surplus Commodity).....	192.33
1 Buffalo-Springfield Roller.....	1,900.00

Appendix B

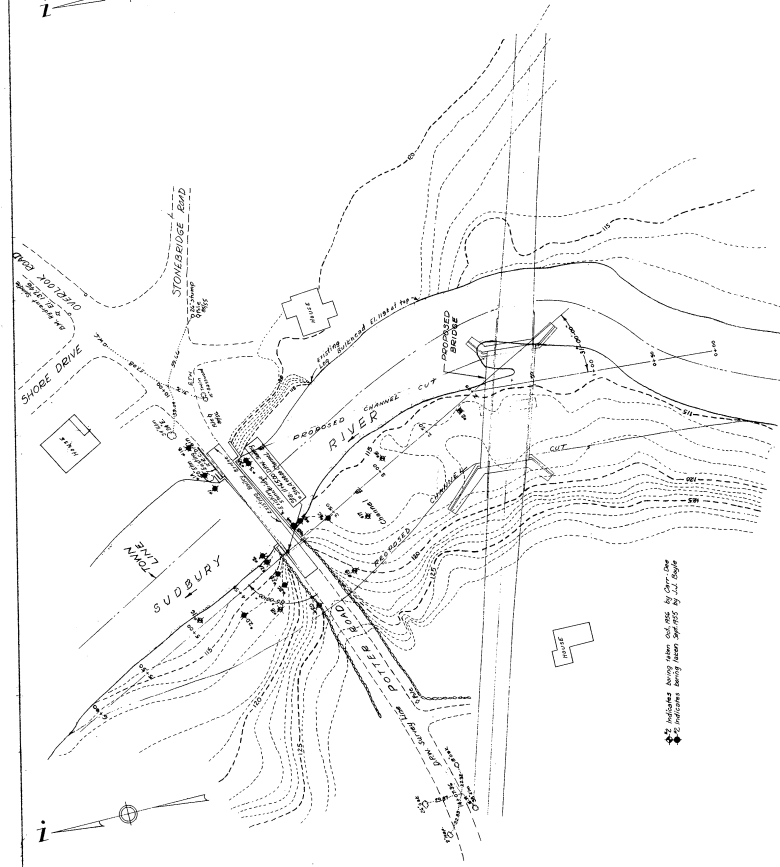

PROPOSED CHANNEL RELOCATION
Scale: 1"=400'

EXISTING CHANNEL LOCATION
Scale: 1"=400'