

Option 1

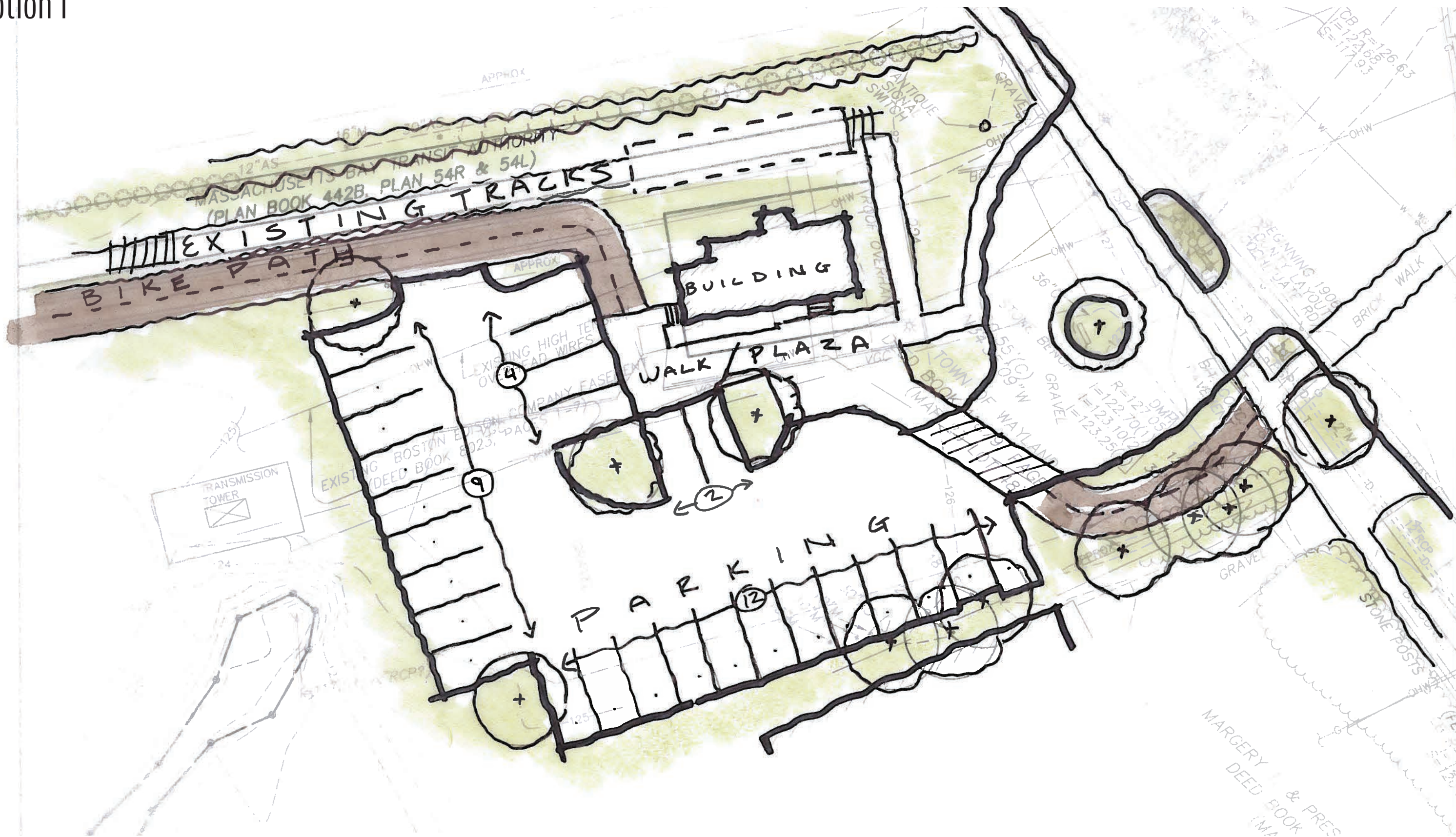

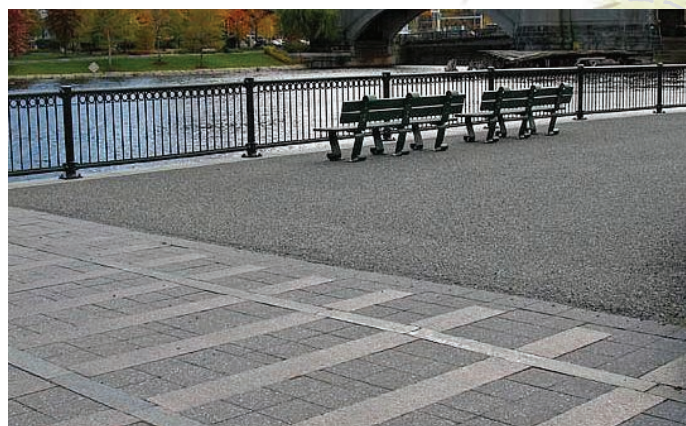

Option 2

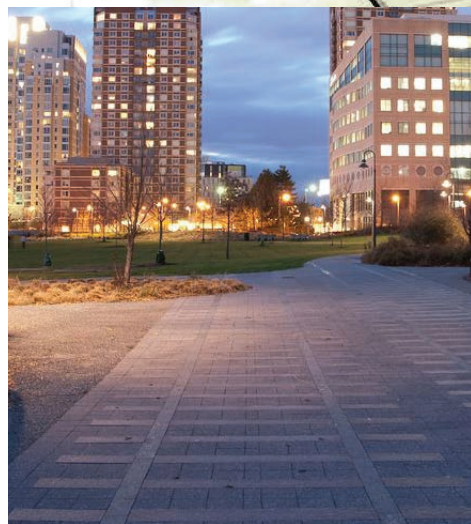
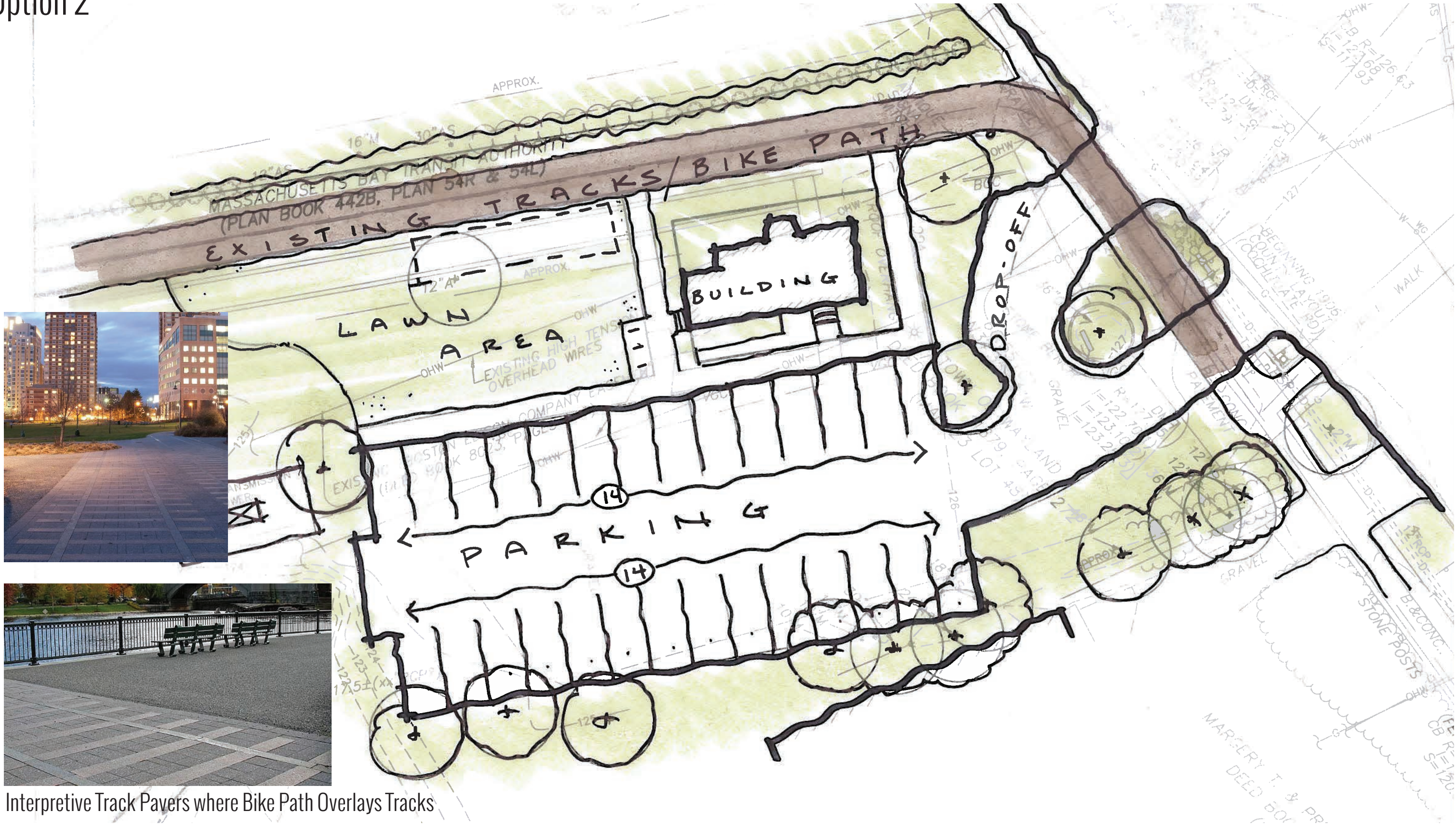

Interpretive Track Pavers where Bike Path Overlays Tracks



This hand-drawn site plan, labeled 'Option 3', illustrates a proposed development. The plan features a central rectangular 'BUILDING' with a hatched roof section. To the north of the building are 'TRACKS' and a 'WALK' area. A 'BIKE PATH' runs along the bottom edge of the site. A 'PARKING' area is located to the east of the building. The plan includes various annotations such as 'EXISTING HIGH TENSION OVERHEAD WIRE', 'APPROX.', and 'PROP. OFF'. A dashed line indicates an 'ALT. ROUTE W/ BOARD WALK'. The drawing is overlaid on a background of technical survey data, including property lines, bearings, and distances.