

ADDENDUM NO. 2

TO

CONTRACT DOCUMENTS

WAYLAND HIGH SCHOOL ATHLETIC FIELD BUILDINGS Wayland, MA

IFB #20-1012

August 19, 2019

NOTICE TO BIDDERS

The attention of all bidders submitting proposals for “Improvements to Wayland High School Athletic Field Buildings” is called to the following Addenda to the specifications and plans. The items set forth herein, whether of omission, addition or substitution are to be included in, and form part of the specifications and plans of the above-named project for bids to be received as advertised.

PLEASE BE SURE TO ACKNOWLEDGE THIS ADDENDUM ON BID PRICING PAGE

The following clarifications, modifications, deletions and additions are hereby incorporated into and become part of the Contract Documents. The project bidding is as follows:

- Final day for questions by filed sub-bids is Aug. 19, 2019, no later than 11:00 AM
- Filed sub-bids are due to be submitted, Aug 22, 2019, no later than 2:00 PM
- Final day for GC.s to ask questions is Aug. 26, 2019, no later than 11:00 AM
- General Bids must be submitted by Aug 29, 2019, no later than 2:00 PM

WRITTEN CHANGES AND CLARIFICATIONS TO SPECIFICATIONS:

1. Specification Section 07 00 02 – ROOFING AND FLASHING FILED SUB-BID REQUIREMENTS (FILED SUB-BID REQUIRED), section 1.01, item C:

ADD: 5. Specification Section 07 31 13, ASPHALT SHINGLE ROOF.

2. **ADD:** Specification Section 07 31 13 – ASPHALT SHINGLE ROOF, pre attachment.

3. Specification Section 08 71 00 – DOOR HARDWARE, section 2.01, item C:

FOR CLARIFICATION: All applicable hardware for the restroom building, concession building, and storage building shall accept locksets and deadlocks as follows:

Schlage Everest Primus on all exterior doors and Schlage Everest on interior doors. The locksets and deadlocks indicated above shall include full-size interchangeable cores. The Contractor shall coordinate the provision of this hardware with Pasek Corporation, 9 West Third Street, South Boston, 02127, 617-269-7110 x151, attn: Ron Powers.

QUESTIONS AND CLARIFICATIONS

1. **Question:** Who is responsible for the grease interceptor?

Response: The Plumbing Contractor shall be responsible for providing the grease interceptor model number GMC 100 as manufactured by Zurn Industries, LLC, 511 W. Freshwater Way, Milwaukee, WI 53204, 855-663-9876, per attachment.

2. **Question:** Who is responsible for providing the water meter? If so, what size meter?

Response: The Plumbing Contractor shall be responsible for providing a 1-inch water meter and shall coordinate the installation requirements with Wayland Public Works Department.

3. **Question:** The Roofing Form for Sub-Bid issued in Addendum #1 call for deduct pricing to provide architectural asphalt shingles in lieu of standing seam metal roof. The note is also on Drawing Sheet A101 which is the restroom roof. Is Alternate #1 at the restroom roof only or is it at both the restroom and concession roofs? A specification for the shingles needs to be provided.

Response: Alternate #1 shall apply to both the restroom building roof and the concession building roof. Refer to the attached Specification Section 07 31 13 – ASPHALT SHINGLE ROOF.

4. **Question:** Specification Section 07 41 13 – STANDING SEAM METAL ROOF includes a specification for snow guard; however, the plans do not show any. Are snow guards in fact required? If so, please provide a layout.

Response: No Downspouts are to be provided. Contractor shall disregard specification subsection indicating snow guard information.

5. **Question:** Although Addendum #1 reissued the Roofing FSB Bid Form, which now shows an alternate for installing asphalt shingles in lieu of the metal roofing, no specification was provided. Please provide a specification clarifying required shingles, underlayment, and metal flashings.

Response: Refer to the attached Specification Section 07 31 13 – ASPHALT SHINGLE ROOF.

6. **Question:** What is the distance from the new panel PPL1 in the new restroom building to the existing panel PP1C and the new panel in the concession building to the existing panel PPSF in the existing high school building? What is the manufacturer of the existing panels?

Response: Refer to Addendum #1, Questions and Clarifications, Clarification #1 indicating the site contractor is responsible for connecting to the existing panels as well as providing conduit and wiring that will stub up to the proposed panel locations in each building.

ATTACHMENTS:

Specification Section 07 31 13 – ASPHALT SHINGLE ROOF
Grease Interceptor Product Cut Sheet

END OF ADDENDUM NO. 2

SECTION 07 31 13

ASPHALT SHINGLE ROOF

(FILED SUB-BID REQUIRED AS PART OF 07 00 02)

PART 1 - GENERAL

1.01 WORK INCLUDED:

This section covers furnishing all labor, equipment and materials to install the asphalt shingle roof system, including flashing as detailed on the drawings as required, and underlayment.

1.02 SUBMITTALS: IN ACCORDANCE WITH REQUIREMENTS OF GENERAL SPECIFICATIONS, SUBMIT THE FOLLOWING:

Provide manufacturer's literature of the materials of this section shall be submitted to the Engineer for review.

Provide actual board of samples for Engineer to review with Owner.

1.03 RELATED WORK:

A. Section 05 12 33, STRUCTURAL STEEL

B. Section 05 31 23, STEEL DECK (ROOF DECK)

C. Section 06 10 00, ROUGH CARPENTRY (vented roof panel assembly)

D. Section 06 20 00, FINISH CARPENTRY

PART 2 - PRODUCTS

2.01 MATERIALS:

A. Shingles shall be standard, self-sealing fiberglass asphalt shingles, with a minimum 25-year warranty, weighing not less than 300 pounds per square. Shingles shall be delivered to the job site in the manufacturer's original package bearing the Underwriters Laboratories, Inc. Class C label. Color shall be selected by the Engineer.

B. Flashing shall be 16 oz. lead coated copper. Nails and screws used in conjunction with flashing shall be copper or stainless steel.

- C. Waterproofing at roof edges shall be a bitumastic cold applied, self-sealing, composite sheet material installed strictly to manufacturer's recommendations.
- D. Underlayment shall be synthetic roof membrane (Ice & water shield) with the following requirements:
- ASTM D226 and D4869 (Physical properties only)
 - Classified for use beneath UL 790 Class A/ASTM E108 Class A fire rated asphalt shingles
 - ICC-ES Evaluation Report (AC 48, AC 188) pending CAN/CSA Standard A220
 - Water Vapor Transmission – ASTM E96 Method A (“dry method”) < 0.2 Perms Method
 - B (“wet method”) < 0.4 Perms
- Basis of Design: DiamondDeck™ High-Performance Synthetic Roofing Underlayment as manufactured by CertainTeed
- E. Ridge vent to provide 18” of “free area” per lineal foot as provided by the asphalt shingle manufacturer.
- F. Aluminum drip edge as recommended by manufacturer's written recommendations.

PART 3 - EXECUTION

3.01 INSTALLATION:

- A. Shingles shall be laid in accordance with manufacturer's instructions. The shingles shall have 5-inch exposure with a 2-inch headlap. Not less than 320 nails per square (4 nails per shingle) shall be used.
- B. Aluminum drip edge as detailed on the drawings shall be supplied and installed under this section. Flashing for pipes penetrating the roof shall be supplied by others and installed under this section.

END OF SECTION

NOTES:

1. FOR GRAVITY APPLICATIONS ONLY.
2. ALL PROCEPTOR® UNITS ARE MANUFACTURED WITH FIBERGLASS REINFORCED PLASTICS. PHYSICAL CHARACTERISTICS AND THICKNESS: POLYESTER RESIN AND E GLASS MINIMUM THICKNESS 3/16" WALL AND 5/16" TOP AND BOTTOM BOWLS.
3. ALL PROCEPTOR® UNITS ARE TO BE INSTALLED IN ACCORDANCE WITH THE MANUFACTURERS INSTALLATION INSTRUCTION.
4. STANDARD PIPING IS SCH. 40 PVC.
5. GMC/OMC/SWC 50 - 300 UNITS COME STANDARD WITH 4" INLET AND OUTLET (OTHER PIPE SIZE OPTIONS AVAILABLE ON REQUEST).
6. EXTENSION COLLAR TO BE ORDERED TO MEET FINISHED GRADE. CUT ON SITE FOR FINAL ADJUSTMENT AND CAULKED WITH SIKAFLEX BY CONTRACTOR FOR WATERTIGHT SEAL.
7. COVERS AVAILABLE FOR H20 TRAFFIC LOADING, PEDESTRIAN LOADING OR ABOVE GROUND INSTALLATION.
8. CONSULT GREEN TURTLE™ FOR OTHER SIZES.
9. 30 YEAR WARRANTY AGAINST LEAKS, AND STRUCTURAL FAILURE.
10. U.S. PATENT #5,746,912; CDN PATENT #2,195,822

SPECIFICATIONS

PIPE SIZE: 4 INCH
 INSTALLATION: BURIED
 ACCESSWAY SIZE: 24 INCHES
 OPTIONS

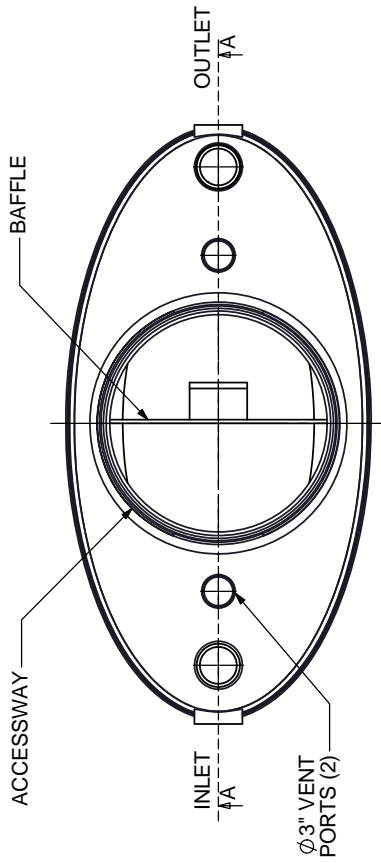

TOP VIEW

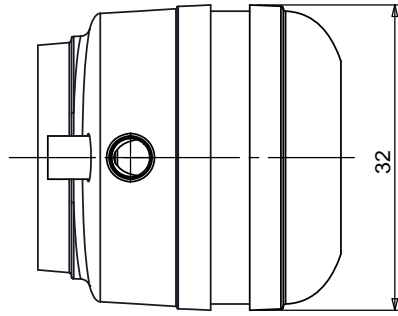

SIDE VIEW

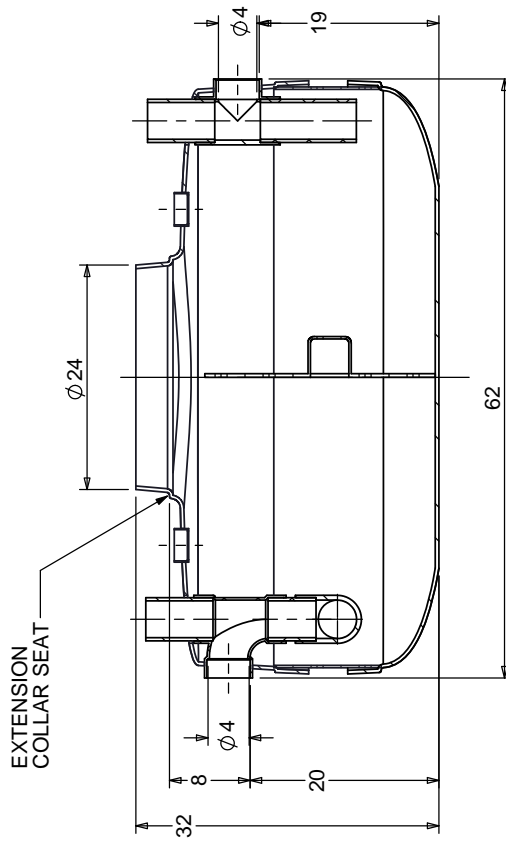

SECTION A-A

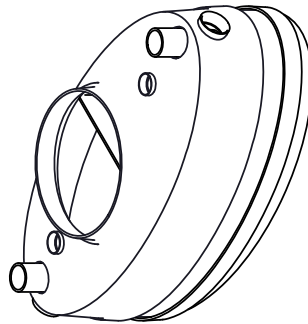

ISOMETRIC VIEW

TITLE: PROCEPTOR® F.O.G. SEPARATOR
 GMC 100

TOTAL WET VOLUME: 100 GAL
 MAX. GREASE CAPACITY: 42 GAL
 MAX SOLIDS CAPACITY: 23 GAL

ALL DIMENSIONS IN INCHES
 PROJECT: WO:

NOTES:

REV	DATE	DRAWN
11	DEC. 02, 2016	
2	MARCH 22, 2017	
3	OCTOBER 27, 2006	L. SIMKINS
5	DEC. 13, 2006	L. SIMKINS
6	NOV. 25, 2008	L. SIMKINS
7	NOVEMBER 3, 2009	L. SIMKINS
8	AUGUST 24, 2011	L. SIMKINS
9	MARCH 27, 2012	L. SIMKINS
10	OCT. 31, 2012	S. MANGAT

CONSULT LOCAL AUTHORITIES FOR
 MINIMUM SIZE OF SEPARATORS

Proceptor®



SIZE DWG. NO. REV.
A GMC 100 **12**

SCALE: 1:20 DO NOT SCALE DRAWING SHEET 1 OF 1