

5/12/2021 1:03 PM C:\PLANNING\LANDSCAPE\03057489_WAYLAND\04\CLAYPIT\062-WAYLAND\PLAYGROUND\AUTOCAD FILES\063-WAY AND PLAYGROUND.DWG

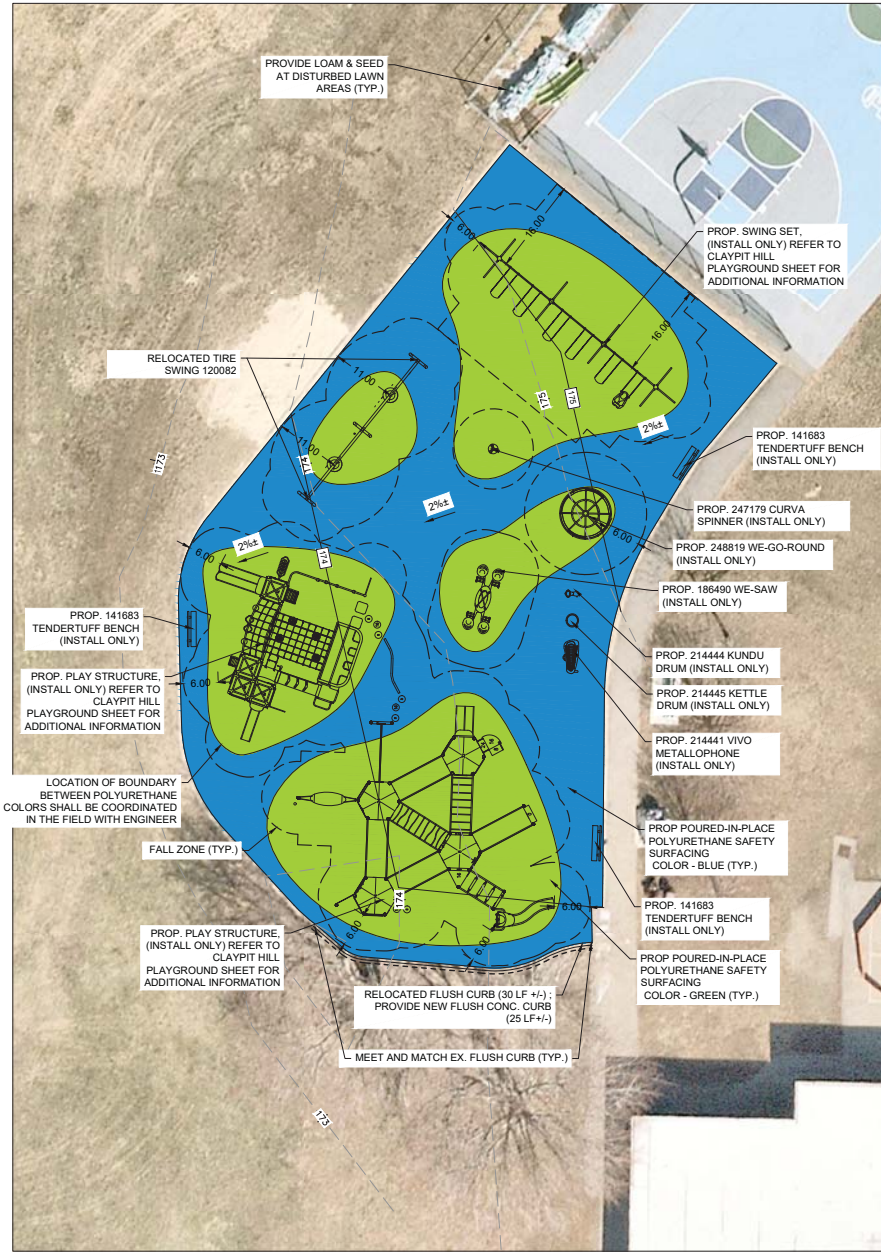

CLAYPIT HILL SCHOOL LAYOUT PLAN
SCALE: 1" = 10' - 0"

RESILIENT SAFETY SURFACING SCHEDULE:	
BLUE:	4150 SF
GREEN:	4100 SF
TOTAL:	8250 SF

PAVEMENT NOTES

POLYURETHANE SAFETY SURFACING
CONTRACTOR TO COORDINATE LAYOUT, DEPTHS, AND GRADES OF POLYURETHANE SAFETY SURFACING WITH PLAYGROUND MANUFACTURER'S REPRESENTATIVE AND INSTALLER.

LAYOUT NOTES

1. CONTRACTOR SHALL VERIFY ALL CONDITIONS IN THE FIELD AND REPORT ANY DISCREPANCIES THAT AFFECT THE LAYOUT OF PROPOSED WORK TO DCR.
2. CONTRACTOR SHALL COORDINATE WITH MANUFACTURER'S REP TO VERIFY LAYOUT OF PLAY STRUCTURES, SAFETY ZONES, AND PANELS WITHIN THE NEW POURED-IN-PLACE POLYURETHANE SAFETY SURFACING PRIOR TO FINAL INSTALLATION.
3. CONTRACTOR MAY BE DIRECTED BY ENGINEER OR EQUIPMENT MANUFACTURER OR REPRESENTATIVE TO INCREASE THE THICKNESS OF THE SAFETY WEARING COURSE UNDER CERTAIN FEATURES AND/OR AT THE BASE OF THE SLIDE.

PREPARED BY



REGISTERED PROFESSIONAL

SUBCONSULTANT

PROJECT

INSTALLATION OF PLAYGROUND EQUIPMENT AND SURFACE

WAYLAND, MA

TITLE

CLAYPIT HILL SCHOOL LAYOUT PLAN

NO.	REVISIONS	DATE

DRAWN BY:	NS
DESIGNED BY:	NS
CHECKED BY:	NS
ISSUE DATE:	00/00/2018
BETA JOB NO.:	0000

NORTH ARROW



SCALE



UNLESS OTHERWISE NOTED OR CHANGED BY REPRODUCTION.

SHEET NO.

07