



**DEPARTMENT OF PUBLIC WORKS
TOWN OF WAYLAND**

✓ *Entrusted To
Manage The
Public
Infrastructure*

Thomas M. Holder
Director

Joseph Doucette
Superintendent

Don Millette
Superintendent

Paul Brinkman
Engineer

Application & Agreement for the Installation of an Underground Irrigation System as Governed by Town Bylaw Chapter 191

Please complete and sign all sections of this application and review the attached Bylaw and guidance documents concerning Irrigation Systems.

Location: 412 Commonwealth Road, Wayland, MA 01778
Proposed Irrigation System Size (Square Feet) 76,035 sf

Owner: Town of Wayland
Address: 41 Cochituate Road, Wayland, MA 01778
Phone & email: _____

Irrigation Installer: M.J. Cataldo, Inc.
Address: PO Box 1343, Littleton, MA 01460
Phone & email: (978) 486-4331, info@mjcataldo.com

Irrigation Application Checklist
All of the following items must be checked prior to permit submittal

- Plumbing Permit attached
• Plumbing Permlt # _____ _____
- Device Design Data Sheet completed for Backflow Device Installation ✓
- Irrigation Plan Requirements**
- "CAD" style Irrigation plan overlaid on the Parcel Plan (must be to scale, see attached) ✓
- Calculated irrigation area shown on the Irrigation Plan ✓
- Location of the entire Septic System identified on Plan N/A
- Irrigation System is not within 25' of any component of Septic System N/A
- Vegetated Wetlands shown on Plan (if any) ✓
- Irrigation System is not within 50' of vegetated wetlands ✓
- Location of Town Right of Way shown on Plan ✓

- No portion of the irrigation system is installed within the Town Right of Way ✓
- Backflow preventer location and specifications identified on Plan ✓
- Rain Gauge location and specifications identified on Plan ✓

I/we understand and agree that the Town of Wayland does not guarantee to furnish constant water pressure or uninterrupted service, and that the Town reserves the right to restrict the use of water during dry seasons or under any emergency condition. Also, I/we understand that the Backflow Prevention Device associated with this Irrigation System must be tested annually by the Water Division or Water Division's Backflow Testing Contractor. The Backflow Device Test Fee will be billed to the owner of the Irrigation System.

Owner Signature: [Signature] Date: 5/19/23

Installer Signature: [Signature] Date: 5/19/23

Irrigation Installer must contact the Water Division for Inspection and Initial Backflow test prior to final approval of system.

FOR INTERNAL USE ONLY
Approval Process

Completed Application Packet submitted to DPW Office for Review. [Signature] 6/13/23
(Signature and Date)

For Applications under 5,000 sq. ft., DPW Director Approval is required. _____
(Signature and date)

For Applications over 5,000 sq. ft., DPW Board Approval is required. [Signature] 7.19.23
(Signature and Date)

Inspection of the installed Irrigation System. [Signature] 8/17/23
(Signature and Date)

Chapter 191. LAWN IRRIGATION SYSTEMS

[HISTORY: Adopted by the Annual Town Meeting of the Town of Wayland 4-3-2003 by Art. 24. Amendments noted where applicable.]

§ 191-1. Statutory authority.

[Amended 4-10-2008 ATM by Art. 5]

This bylaw is adopted by the Town of Wayland under its common law police powers to protect public health and welfare, MGL c. 40, § 21, and under the Town of Wayland's authority to regulate water use through its Board of Public Works pursuant to Chapter 80 of the Acts of 1878.

§ 191-2. Purpose.

The purpose of this bylaw is to protect, preserve and maintain the public water supply, health, safety and welfare of the citizens of the Town of Wayland.

§ 191-3. Definitions.

As used in this bylaw, the following terms shall have the meanings indicated:

OUTDOOR UNDERGROUND WATER SPRINKLER SYSTEM

Any underground sprinkler device, together with all pipes appurtenant thereto, used to water outside areas, and hereafter referred to as "system" or "systems." Aboveground sprinklers attached to hoses and existing systems, so long as they are not expanded, are specifically exempt from the provisions of this article.

PERSON

Any individual, corporation, trust, partnership or association or other entity.

PUBLIC WATER SUPPLY

Any water which is fully or partially drawn from a well operated by the Town of Wayland.

THIS BYLAW

Chapter 191 of the Code of the Town of Wayland.

WATER CUSTOMER

Any individual, corporation, trust, partnership or association or other entity that owns property which is receiving water from the public water supply.

§ 191-4. Certain outdoor underground water sprinkler systems prohibited.

No person shall install or expand a system which is connected to the public water supply if said system, after installation or expansion covers, an area greater than 15,000 square feet or more.

§ 191-5. Application for installation or expansion of certain systems.

No person shall install or expand a system connected to the public water supply, which covers an area of 15,000 square feet or less unless an application has been made to pursuant to this bylaw and approval of said installation or expansion has been approved pursuant to this bylaw.

§ 191-6. Types of applications.

A.

Any application for the installation or expansion of a system which covers an area of 5,000 square feet or less shall be made by completing the short-form application.

B.

Applications for the installation or expansion of a system which covers an area of more than 5,000 square feet and less than or equal to 15,000 square feet shall be made by completing the long-form application.

§ 191-7. System requirements.

A.

All systems installed or expanded under this bylaw shall be installed or expanded pursuant to all local and state laws and regulations and shall include a backflow device (approved by the Department of Public Works), a rain gauge, a moisture detector, a programmable automatic timer and a shut-off valve.

[Amended 5-13-2010 ATM by Art. 18]

B.

All systems installed or expanded under this bylaw shall obtain an appropriate plumbing permit from the Gas and Plumbing Inspector of the Town of Wayland.

C.

All systems installed or expanded under this bylaw shall be maintained pursuant to the regulations of the Board of Public Works.

[Amended 5-13-2010 ATM by Art. 18]

D.

All systems installed or expanded under this bylaw shall be installed outside of any road easements, which run in the favor of the Town of Wayland, and any roads owned by the Town of Wayland.

E.

No portion of a system shall be installed or expanded within 50 feet of bordering vegetated wetlands.

CONTINUED

F.

No portion of a system shall be installed or expanded within 25 feet of the leaching area or a tank of a sanitary septage system.

§ 191-8. Approval process.

A.

Fees. All applications to install or expand a system shall include an application fee of \$50.

B.

The application shall include the name and address of the property owner and the installer, acknowledgement of the requirements of this bylaw, a drawing and calculation of the area covered by the system and any additional information the Board of Public Works requires to reasonably identify and evaluate the compliance of the proposed system.

[Amended 4-10-2008 ATM by Art. 5]

C.

The Director of Public Works or his/her designee shall approve the short-form application if s/he determines that said system covers a land area of 5,000 square feet or less and complies with the provisions of this bylaw.

[Amended 5-13-2010 ATM by Art. 18]

D.

The long-form application shall be approved by the Board of Public Works or designee if the Board of Public Works or designee determines that said system covers a land area of 15,000 square feet or less and complies with the provisions of this bylaw.

[Amended 4-10-2008 ATM by Art. 5]

§ 191-9. Rules and regulations.

[Amended 4-10-2008 ATM by Art. 5]

The Wayland Board of Public Works shall have the authority and duty to adopt, issue and administer any additional rules and regulations necessary for the administration, operation and enforcement of outdoor underground water sprinkler systems connected to the public water supply. Any such rules and regulations shall be consistent with the provision of this bylaw.

§ 191-10. Violations and penalties.

Any person violating this bylaw shall be subject to the following:

A.

Written notification of a violation by the Director of Public Works or his/her designee. Said notification shall include a demand that said system comply with the bylaw within 30 days' receipt of the notification or that said system be removed.

[Amended 4-10-2008 ATM by Art. 5; 5-13-2010 ATM by Art. 18]

B.

A fine of \$250 per day for each day after the initial 30 days that the system is in violation of this bylaw.

C.

After the initial 30 days, a notice of termination of water services in no less than seven days may be served upon the water customer by a duly appointed Constable of the Town of Wayland. The notice shall be served to the water customer in hand or left at the address given for billing purposes and mailed to that address. Notice shall include a statement that the water customer may appeal a decision to terminate water services by requesting a hearing before the Board of Public Works. Water service may be terminated seven days after receipt of the notice to terminate or after a majority vote of the Board of Public Works, if the water customer has requested a hearing. Receipt of the notice shall be presumed to be three days after the notice is mailed or the day of in-hand service. After water service has been terminated, a reconnection fee of \$275 during normal business hours, or reconnection fee of \$200 after normal working hours, will be charged prior to renewing water service. Payment of said fees must be made before reconnection. In lieu of terminating water services, the Board of Public Works, by a majority vote, may assess a fine in the amount of \$250 per day for each day after the initial 30 days that the system is in violation of this bylaw.

[Amended 4-10-2008 ATM by Art. 5]

D.

Fines shall be recovered by indictment or on complaint before the District Court or by noncriminal disposition in accordance with MGL c. 40, § 21D. After disposition favorable to the Town of Wayland, any outstanding unpaid civil fines shall be placed on the water customer's water bill. The enforcing person shall be the Director of Public Works or his/her designee.

[Amended 5-13-2010 ATM by Art. 18]

§ 191-11. Severability.

The invalidity of any portion or provision of this bylaw shall not invalidate any other portion or provision thereof.

OPERATION NOTES

1. COORDINATE FINAL LOCATION OF SPRINKLERS AND NOZZLE SELECTION WITH FINAL APPROVED FIELD LAYOUT.

2. ALL WIRE AND VALVE LOCATIONS ARE DIAGRAMMATIC. CONTRACTOR SHALL FIELD VERIFY.

3. ALL VALVES AND VALVE BOXES SHALL BE PLACED WHERE POSSIBLE AWAY FROM PLANTER SURFACES.

4. ALL CONTROL WIRE SHALL BE #14 GAUGE SHIELDED STRAND WIRE FOR TWP ZONES. ALL CONTROL WIRE SHALL BE TO BRASS SHIELD BRASS HOUSING AND ALL BRASS HOUSING SHALL BE TO BRASS SHIELD BRASS HOUSING AND ALL BRASS HOUSING SHALL BE TO BRASS SHIELD BRASS HOUSING.

5. BRASS COUPLING VALVES SHALL BE RETAILED ON 1/2" NPT PVC BRASS JOINTS WITH BRASS HOUSING AND STABILIZED. SEE DETAIL.

6. ALL RETAIN SPRINKLERS SHALL BE RETAILED ON 1/2" NPT PVC BRASS JOINTS WITH BRASS HOUSING AND STABILIZED. SEE DETAIL.

7. IRRIGATION SYSTEM IS DESIGNED FOR SEPARATE WATER SUPPLY TO PROVIDE AT LEAST 100 GPM PER SPRINKLER. DESIGN TO PROVIDE 100 GPM PER SPRINKLER. CONTRACTOR SHALL TEST SYSTEM PRESSURE BEFORE STARTING WORK. REPORT ANY OBSERVATIONS FROM PRESSURE TEST TO OWNER'S REPRESENTATIVE BEFORE STARTING.

OPERATION NOTES

1. INSTALL CONTROLLER IN ENCLOSURE, GENERALLY 1 FEET SHORT OF THE EXISTING WALK WIRE TO OR HOLE. COORDINATE WITH ANY EXISTING TOWER SUPPLY USING LICENSED ELECTRICIAN. ROUTE ALL WIRE AND BRASS FITTINGS TO CONTROLLER VIA CONDUIT THROUGH ENCLOSURE WALL.

2. INSTALL RAIN SENSOR ON OUTSIDE OF CONTROLLER ENCLOSURE. ROUTE RAIN SENSOR WIRE TO CONTROLLER THROUGH ENCLOSURE WALL.

3. COORDINATE LOCATION OF ALL BRASSING AND VALVES INSTALLED ON SITE AND CONTACT PROPERTY SUPERVISOR AND FIELD CONTRACTOR BEFORE THE START OF WORK.

4. FLUSH ALL LATERAL LINES BEFORE INSTALLING SPRINKLERS.

5. CONTRACTOR MUST SUBMIT SHOP DRAWINGS AS PER THE WRITTEN SPECIFICATIONS TO THE IRRIGATION CONSULTANT FOR APPROVAL PRIOR TO ORDERING MATERIAL AND BEGINNING WORK.

6. ALL WIRE AND ALL MATERIAL, SUBSTITUTIONS FROM VENDOR FROM NO RELEASED PRODUCTS MUST BE SUBMITTED TO THE IRRIGATION CONSULTANT FOR APPROVAL AS PART OF THE SUBMITTAL PROCESS.

7. ONCE APPROVED SHOP DRAWINGS HAVE BEEN REFERRED TO THE CONTRACTOR, WORK MAY BEGIN. THE IRRIGATION CONSULTANT MUST BE NOTIFIED A MINIMUM OF 72 HOURS IN ADVANCE OF THE START OF WORK TO COORDINATE ON-SITE SUPERVISION AND ADMINISTRATION.

8. SEE IRRIGATION DETAILS AND SPECIFICATIONS SECTION FOR ADDITIONAL NECESSARY INFORMATION.

OPERATION LEGEND

SYMBOL	NO.	SPACE	DESCRIPTION
○	1	1	1/4" VOLT ELECTRIC BONE VALVE
○	2	1	2" VALVE REGULATOR FOR FLOW AND PRESSURE
○	3	1	ISOLATION GATE VALVE (SHALL BE 2" DIA)
○	4	1	2" BRASS COUPLING VALVE
○	5	1	2" BRASS COUPLING VALVE
○	6	1	2" BRASS COUPLING VALVE
○	7	1	2" BRASS COUPLING VALVE
○	8	1	2" BRASS COUPLING VALVE
○	9	1	2" BRASS COUPLING VALVE
○	10	1	2" BRASS COUPLING VALVE
○	11	1	2" BRASS COUPLING VALVE
○	12	1	2" BRASS COUPLING VALVE
○	13	1	2" BRASS COUPLING VALVE
○	14	1	2" BRASS COUPLING VALVE
○	15	1	2" BRASS COUPLING VALVE
○	16	1	2" BRASS COUPLING VALVE
○	17	1	2" BRASS COUPLING VALVE
○	18	1	2" BRASS COUPLING VALVE
○	19	1	2" BRASS COUPLING VALVE
○	20	1	2" BRASS COUPLING VALVE
○	21	1	2" BRASS COUPLING VALVE
○	22	1	2" BRASS COUPLING VALVE
○	23	1	2" BRASS COUPLING VALVE
○	24	1	2" BRASS COUPLING VALVE
○	25	1	2" BRASS COUPLING VALVE
○	26	1	2" BRASS COUPLING VALVE
○	27	1	2" BRASS COUPLING VALVE
○	28	1	2" BRASS COUPLING VALVE
○	29	1	2" BRASS COUPLING VALVE
○	30	1	2" BRASS COUPLING VALVE
○	31	1	2" BRASS COUPLING VALVE
○	32	1	2" BRASS COUPLING VALVE
○	33	1	2" BRASS COUPLING VALVE
○	34	1	2" BRASS COUPLING VALVE
○	35	1	2" BRASS COUPLING VALVE
○	36	1	2" BRASS COUPLING VALVE
○	37	1	2" BRASS COUPLING VALVE
○	38	1	2" BRASS COUPLING VALVE
○	39	1	2" BRASS COUPLING VALVE
○	40	1	2" BRASS COUPLING VALVE
○	41	1	2" BRASS COUPLING VALVE
○	42	1	2" BRASS COUPLING VALVE
○	43	1	2" BRASS COUPLING VALVE
○	44	1	2" BRASS COUPLING VALVE
○	45	1	2" BRASS COUPLING VALVE
○	46	1	2" BRASS COUPLING VALVE
○	47	1	2" BRASS COUPLING VALVE
○	48	1	2" BRASS COUPLING VALVE
○	49	1	2" BRASS COUPLING VALVE
○	50	1	2" BRASS COUPLING VALVE
○	51	1	2" BRASS COUPLING VALVE
○	52	1	2" BRASS COUPLING VALVE
○	53	1	2" BRASS COUPLING VALVE
○	54	1	2" BRASS COUPLING VALVE
○	55	1	2" BRASS COUPLING VALVE
○	56	1	2" BRASS COUPLING VALVE
○	57	1	2" BRASS COUPLING VALVE
○	58	1	2" BRASS COUPLING VALVE
○	59	1	2" BRASS COUPLING VALVE
○	60	1	2" BRASS COUPLING VALVE
○	61	1	2" BRASS COUPLING VALVE
○	62	1	2" BRASS COUPLING VALVE
○	63	1	2" BRASS COUPLING VALVE
○	64	1	2" BRASS COUPLING VALVE
○	65	1	2" BRASS COUPLING VALVE
○	66	1	2" BRASS COUPLING VALVE
○	67	1	2" BRASS COUPLING VALVE
○	68	1	2" BRASS COUPLING VALVE
○	69	1	2" BRASS COUPLING VALVE
○	70	1	2" BRASS COUPLING VALVE
○	71	1	2" BRASS COUPLING VALVE
○	72	1	2" BRASS COUPLING VALVE
○	73	1	2" BRASS COUPLING VALVE
○	74	1	2" BRASS COUPLING VALVE
○	75	1	2" BRASS COUPLING VALVE
○	76	1	2" BRASS COUPLING VALVE
○	77	1	2" BRASS COUPLING VALVE
○	78	1	2" BRASS COUPLING VALVE
○	79	1	2" BRASS COUPLING VALVE
○	80	1	2" BRASS COUPLING VALVE
○	81	1	2" BRASS COUPLING VALVE
○	82	1	2" BRASS COUPLING VALVE
○	83	1	2" BRASS COUPLING VALVE
○	84	1	2" BRASS COUPLING VALVE
○	85	1	2" BRASS COUPLING VALVE
○	86	1	2" BRASS COUPLING VALVE
○	87	1	2" BRASS COUPLING VALVE
○	88	1	2" BRASS COUPLING VALVE
○	89	1	2" BRASS COUPLING VALVE
○	90	1	2" BRASS COUPLING VALVE
○	91	1	2" BRASS COUPLING VALVE
○	92	1	2" BRASS COUPLING VALVE
○	93	1	2" BRASS COUPLING VALVE
○	94	1	2" BRASS COUPLING VALVE
○	95	1	2" BRASS COUPLING VALVE
○	96	1	2" BRASS COUPLING VALVE
○	97	1	2" BRASS COUPLING VALVE
○	98	1	2" BRASS COUPLING VALVE
○	99	1	2" BRASS COUPLING VALVE
○	100	1	2" BRASS COUPLING VALVE

OPERATION LEGEND

SYMBOL	DESCRIPTION
○	IRRIGATION WATER METER
○	BACKFLOW PREVENTION DEVICE
○	ISOLATION GATE VALVE FOR CONTROL VALVES
○	2" BRASS VALVE
○	2" BRASS STOP

VALVE DESIGNATION

STATION NO.

FLUSH

VALVE SIZE

CALCULATED IRRIGATED AREA
76,035 SF

SPRINKLER HEAD: MODEL 125 SSK WATER INDUSTRIES
BACKFLOW DEVICE: MODEL LF003MATTIS
RAIN SENSOR: MODEL RAN-12 CHLANTER INDUSTRIES

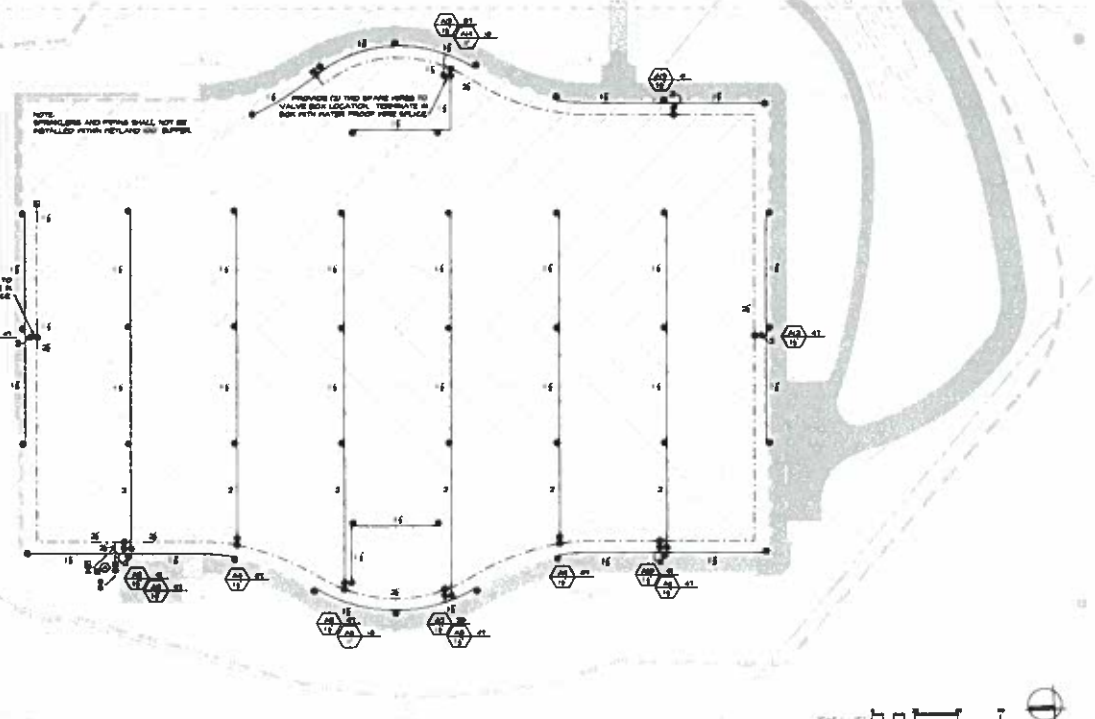

Project: IMPROVEMENTS TO LOWER CONSERVATION AND RESTORATION AREA

City of Seattle
1500 BROADWAY, 3RD FLOOR
SEATTLE, WA 98101

Weston Group
1000 1st Avenue
Seattle, WA 98101
415.222.2222
www.westongroup.com

Contractor: **irrigation**

Scale: 1" = 40'

Sheet No: IR1.00

Project No: 1500000000

Revision: 1

Drawn By: [Name]

Checked By: [Name]

Approved By: [Name]

Date: [Date]

Project Name: IRRIGATION PLAN

Sheet Number: IR1.00



**TOWN OF WAYLAND
DEPARTMENT of PUBLIC WORKS
WATER DIVISION**

**66 RIVER ROAD
WAYLAND, MASSACHUSETTS 01778**

BACKFLOW DEVICE DESIGN DATA AND PLUMBING PLAN

MUST BE SUBMITTED PRIOR TO INSTALLATION

SUBMIT COMPLETED FORM TO:

TOWN OF WAYLAND – DEPARTMENT OF PUBLIC WORKS
WATER DIVISION
66 RIVER ROAD
WAYLAND, MA 01778

PROPERTY OWNER INFORMATION:

Town of Wayland

Owner

41 Cochituate Road

Street Address

Wayland

MA

01778

City

State

Zip Code

FACILITY INFORMATION:

Loker Conservation and Recreation Area

Facility Name

412 Commonwealth Road

Street Address

Wayland

MA

01778

City

State

Zip Code

Ben Keefe

bkeefe@wayland.ma.us

508-358-3786

Contact Person

E-mail

Phone Number

Is this Facility: New or Existing (check one)

Describe the type of business or activities carried out at this facility: Recreation field and walking trails

DEVICE DATA:

Inside irrigation cabinet located adjacent to the maintenance access in the north western corner of the field

Exact Device Location

Watts LF009 2" Cold

Make Model Size Hot or Cold Water Unit

2" ball valves

Type of Gate Valve

RBPB DCVA PVB By-pass Arrangement Yes No

From contamination associated with landscape irrigation.

From what type of contamination is the water supply protected?

CROSS CONNECTION PLAN SUBMITTAL REQUIREMENTS:

1. Completed Device Design Data Sheet
2. Schematic or blueprint of plumbing system (at least 8 1/2" x 11") detailing:
 - a. Location of upstream & downstream shut off valves
 - b. Make, model, size and alignment of device
 - c. Location of potable / non-potable water lines
 - d. System, source, or equipment fed downstream of device, complete with information on the secondary system (operating pressure, chemical treatment, ect.)
 - e. Add devices must be installed in accordance with 310 CMR 22.22

This Design Data Sheet is only for approval of a backflow device installation. All other permits must be acquired by the respective town offices.

Weston & Sampson, Inc.

Submitted By
85 Devonshire Street, 3rd Floor, Boston, MA 02109

Address
5/23/2023 gaala@wseinc.com 508-203-8318
Date E-mail Phone / Fax Numbers

Plumping Permit #

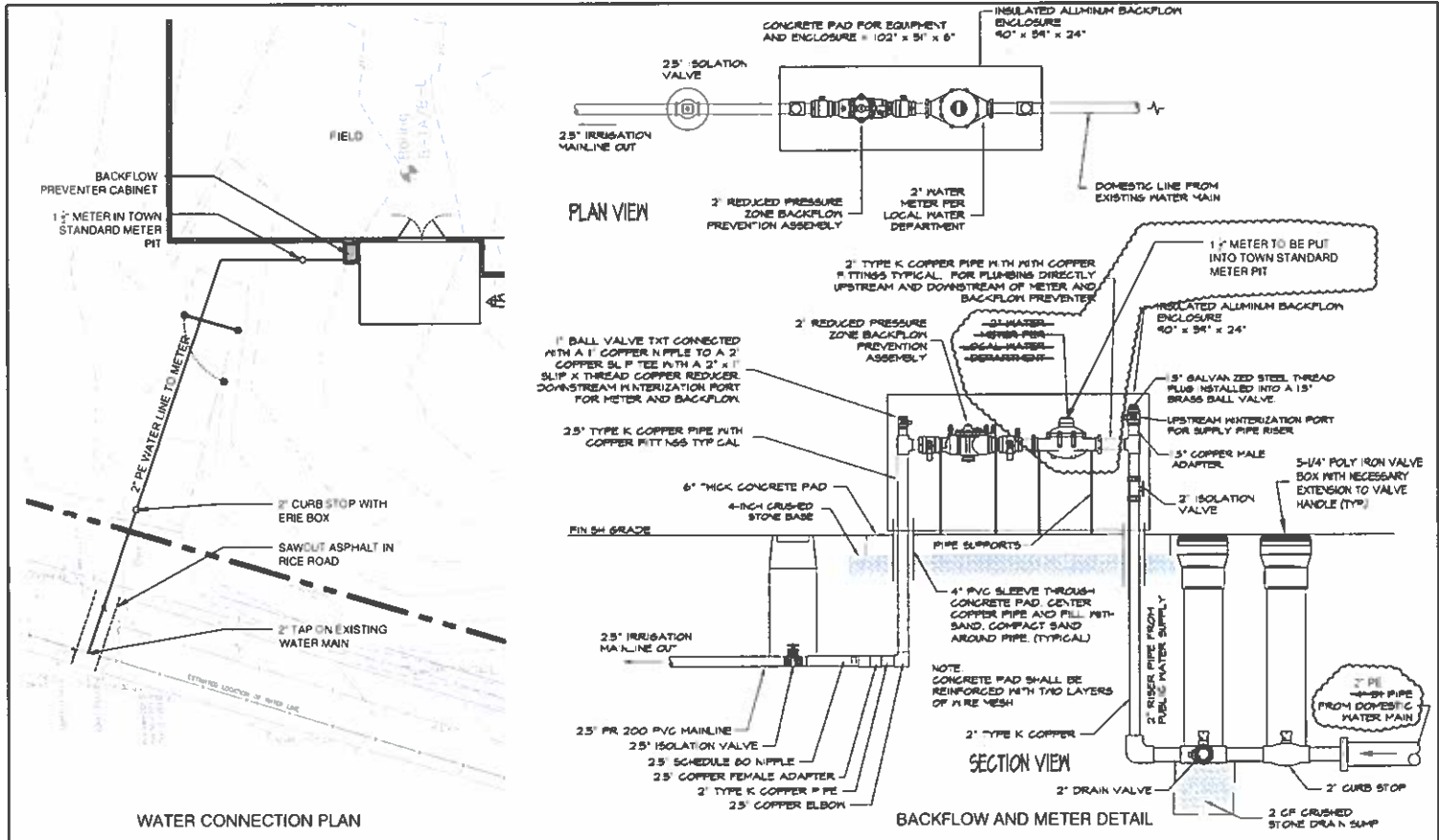

WATER CONNECTION PLAN

BACKFLOW AND METER DETAIL

Weston & Sampson

85 Devonshire Street
 3rd Floor Boston, MA 02109
 617 412 4480 800 SAMPSON
 www.westonandsampson.com



BACKFLOW DEVICE DESIGN

IMPROVEMENTS TO LOKER CONSERVATION AND RECREATION AREA

DATE: 5/23/2023

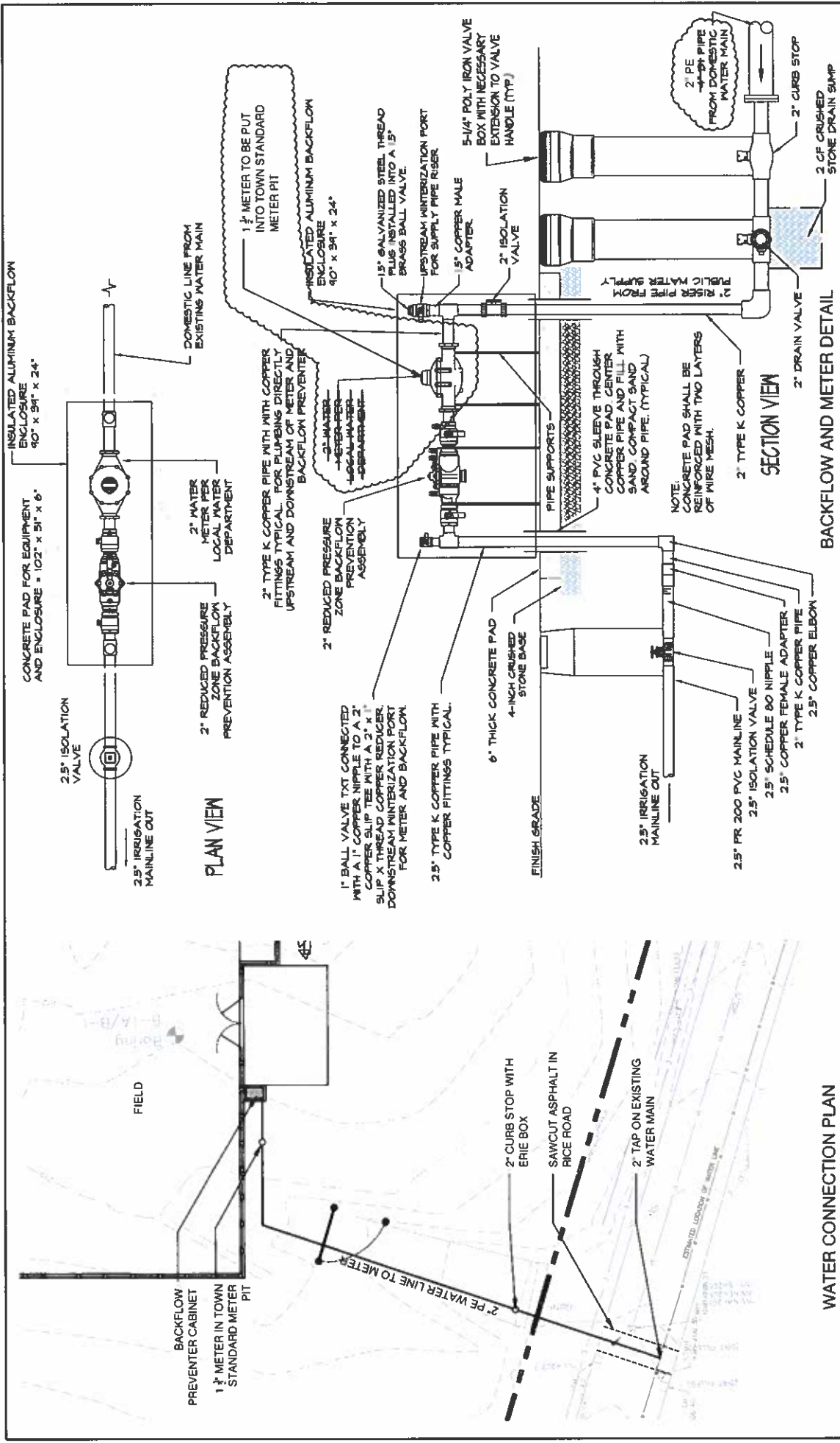

WESTON & SAMPESON

85 Devonshire Street
3rd Floor, Boston, MA 02109
617.472.4480 800.SAMPESON
www.westonandsampson.com

WATER CONNECTION PLAN

BACKFLOW DEVICE DESIGN

IMPROVEMENTS TO LOKER CONSERVATION AND RECREATION AREA

DATE 5/23/2023